

SCROLLSAW WORKSHOP

WWW.SCROLLSAWWORKSHOP.BLOGSPOT.COM

Digital Patterns

Designed by Steve Good



Hundreds of free Patterns
Stencil Printer
Jigsaw Puzzle Templates
DVD's
Key Chain Pattern Printer
Video Tutorials
Reviews
Community Forum and more.

If you would like
to donate click
here. No Paypal
account needed.



Note to commercial print employees: I give my permission to print as many of this pattern book as your customer requires.

steve@stevedgood.com

Copyright Steve Good 2017



General Pattern Information

You may use this pattern to make as many of the project as you like. You are free to use any technique including mass production to build the project. The pattern may be copied and given to others provided the entire book is kept intact. You may not sell the pattern or include it in another commercial package of any type.

Steve Good retains the right to the pattern. If you have any questions about the use of this pattern please contact me at steve@stevedgood.com

When printing this pattern it is important to print it full size. When you bring up the print dialog box look in the “Page Sizing & Handling” section. Make sure the “Actual Size” is selected before you hit print.

You also only need to print the page/s you need. After the print dialog opens look for the “Pages to Print” section. You can print the current page or a range of pages. This will help save ink by not printing the title/instruction pages.

Printing Instructions



Knock Down Portrait Frame



 **HERITAGE**
WOOD SPECIALTIES

Special Offer
Free shipping on orders over \$100

Nationally recognized seller of quality
hardwoods for woodworkers across
the US and Canada

Check out the beautiful scroll saw blanks.
www.heritagewood.com

Limited Time Offer



Prepare your wood and acrylic blanks.
I used a .093" thickness acrylic sheet.

I sandwiched the acrylic and the backer board with blue painters tape. They will be stack cut.

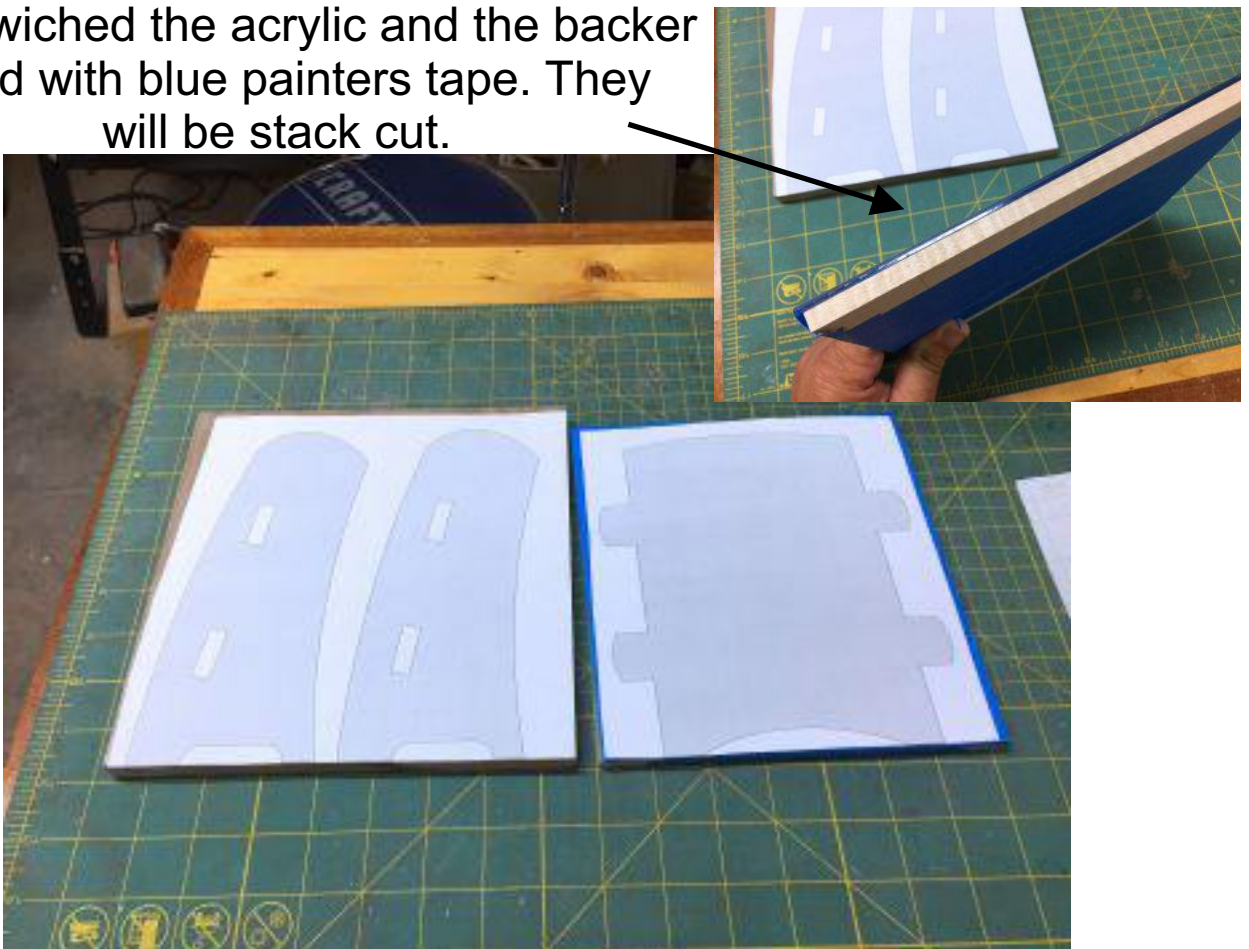

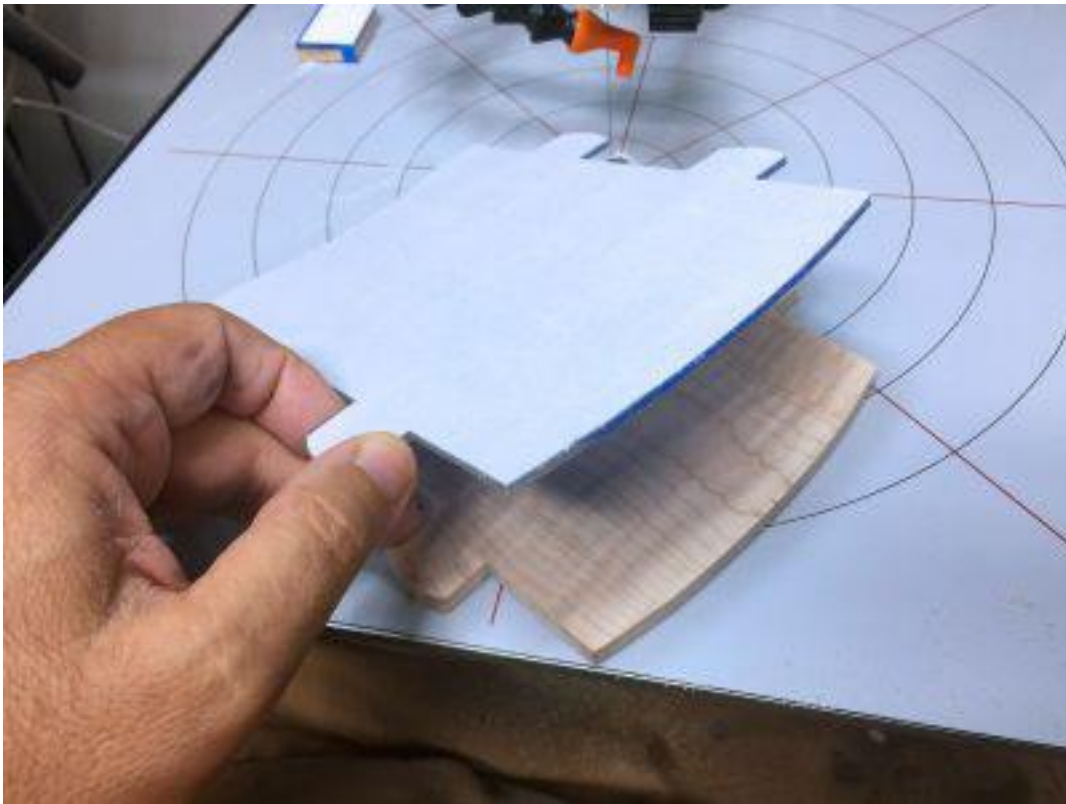

Cut all the pieces. Separate the acrylic sheet from the wood backer and set it aside. The frame will not be glued together so finish the projects with spray acrylic as individual pieces.





When you cut the slots for the tabs make sure you end up with a tight fit for the tabs and the acrylic sheet. The fit will hold the frame together. This way you can knock it down to remove the picture.

If the fit is tight you won't need to tape or glue the picture to the backer board.



1/2" Thick

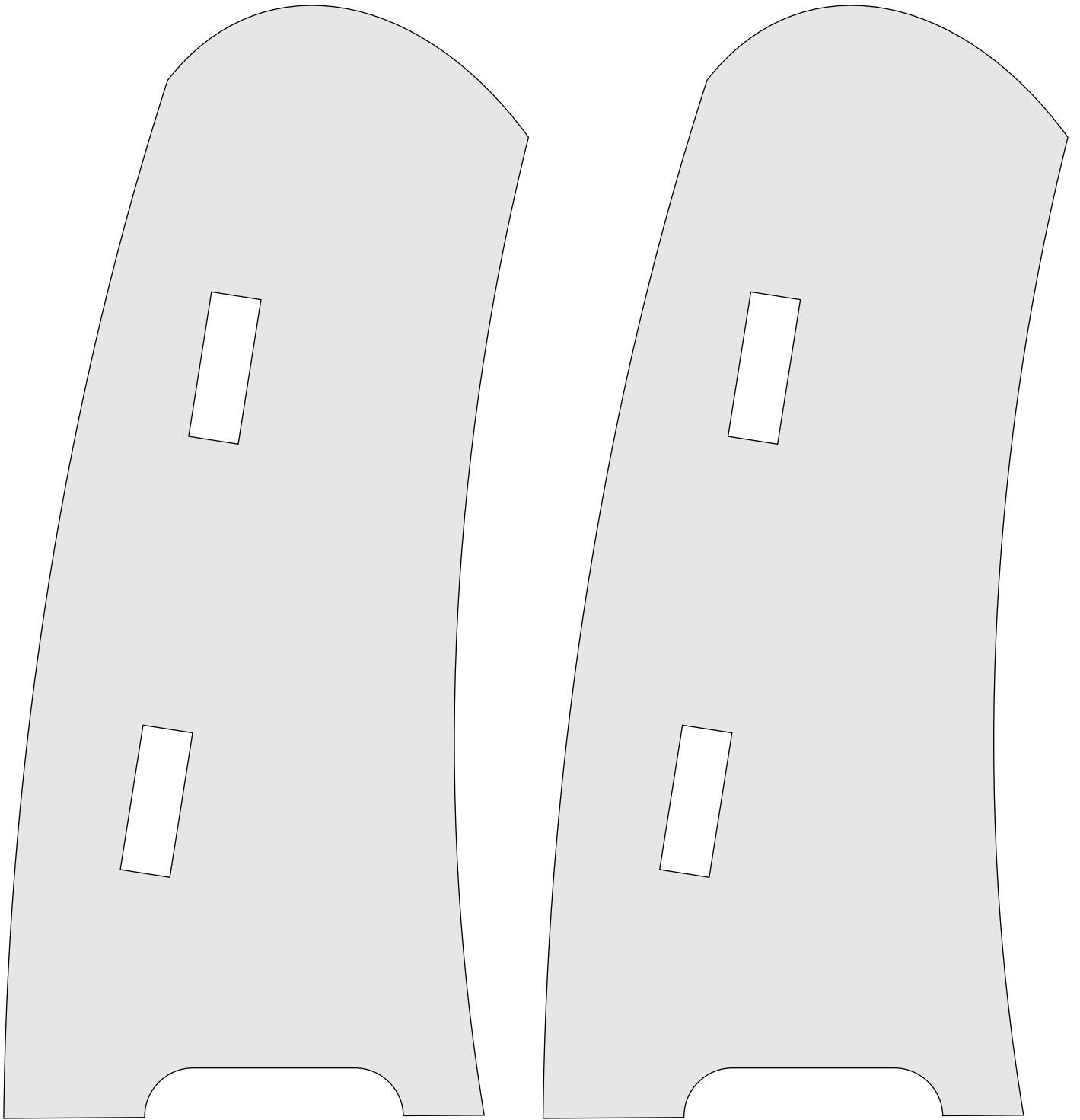

Portrait Orientation

Wood is 1/4" thick
Acrylic is .093" thick

Use this template to stack cut the wood backer
and the acrylic sheet. You can change the slot
size in the sides to accommodate different
thicknesses of acrylic sheet. I used .093" acrylic.

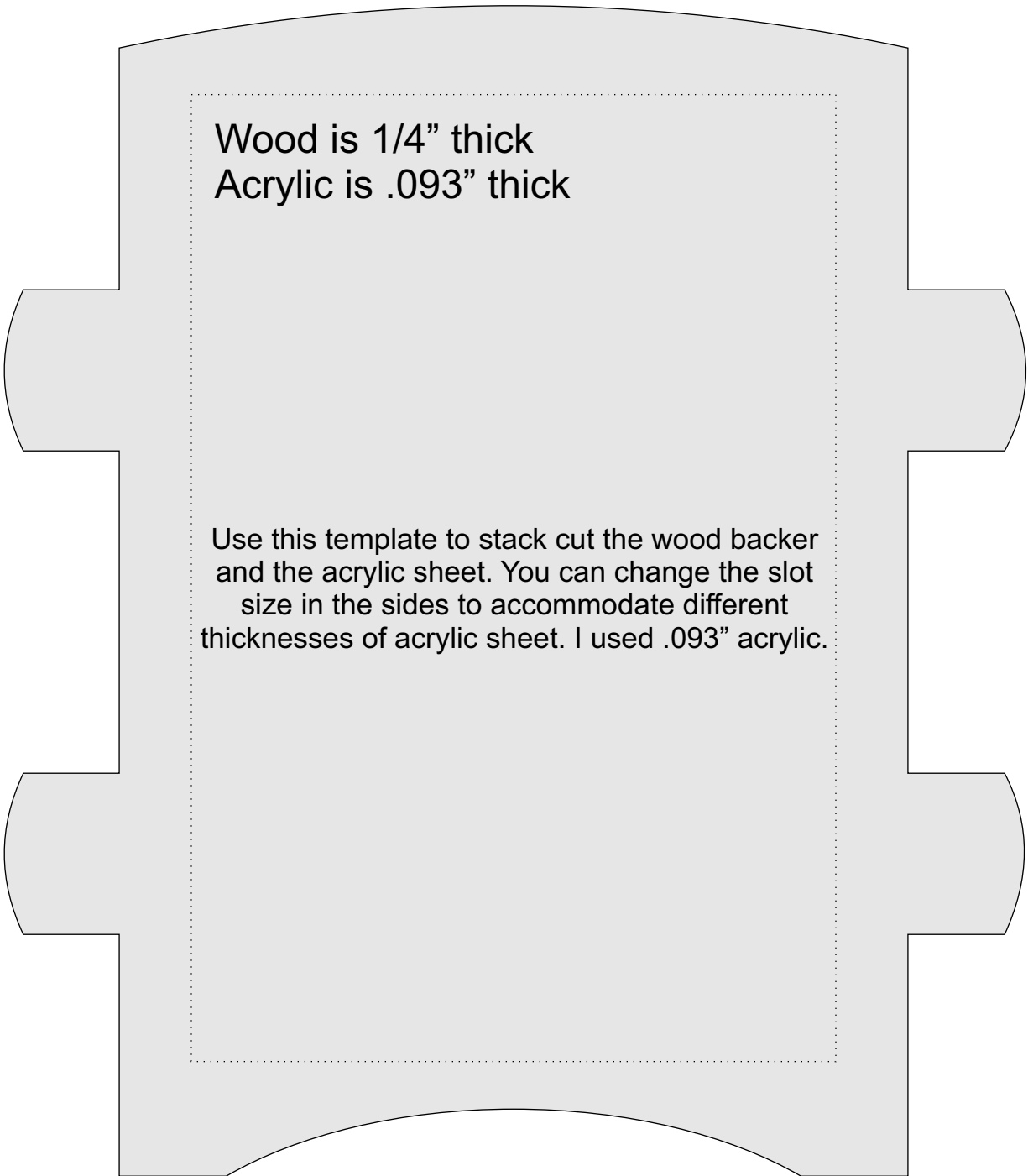



Landscape Orientation

Wood is 1/4" thick
Acrylic is .093" thick

Use this template to stack cut the wood backer
and the acrylic sheet. You can change the slot
size in the sides to accommodate different
thicknesses of acrylic sheet. I used .093" acrylic.