

SCROLLSAW WORKSHOP

WWW.SCROLLSAWWORKSHOP.BLOGSPOT.COM

Digital Patterns

Designed by Steve Good



Hundreds of free Patterns
Stencil Printer
Jigsaw Puzzle Templates
DVD's
Key Chain Pattern Printer
Video Tutorials
Reviews
Community Forum and more.



Note to commercial print employees: I give my permission to print as many of this pattern book as your customer requires.

steve@stevetgood.com

Copyright Steve Good 2014

Men's Initial Ring.



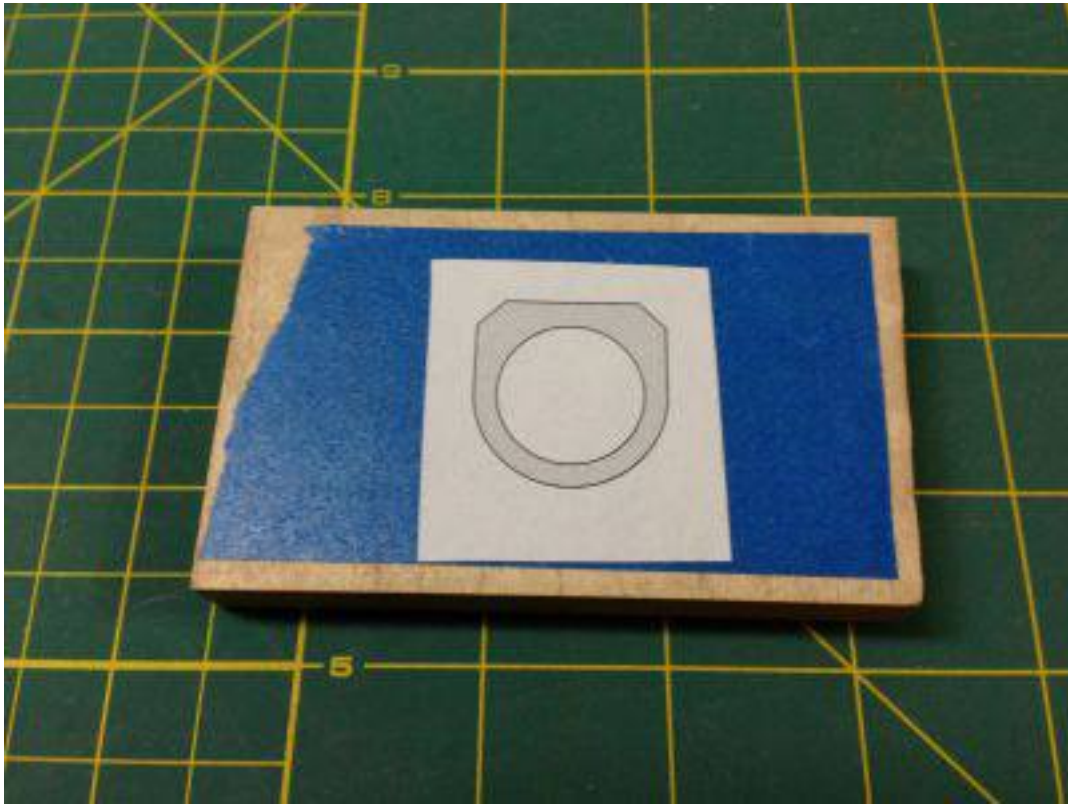

Apply the pattern to the 1/2" thick wood blank.
Cut the ring out. Cut carefully on the interior cut so
you don't change the size too much.

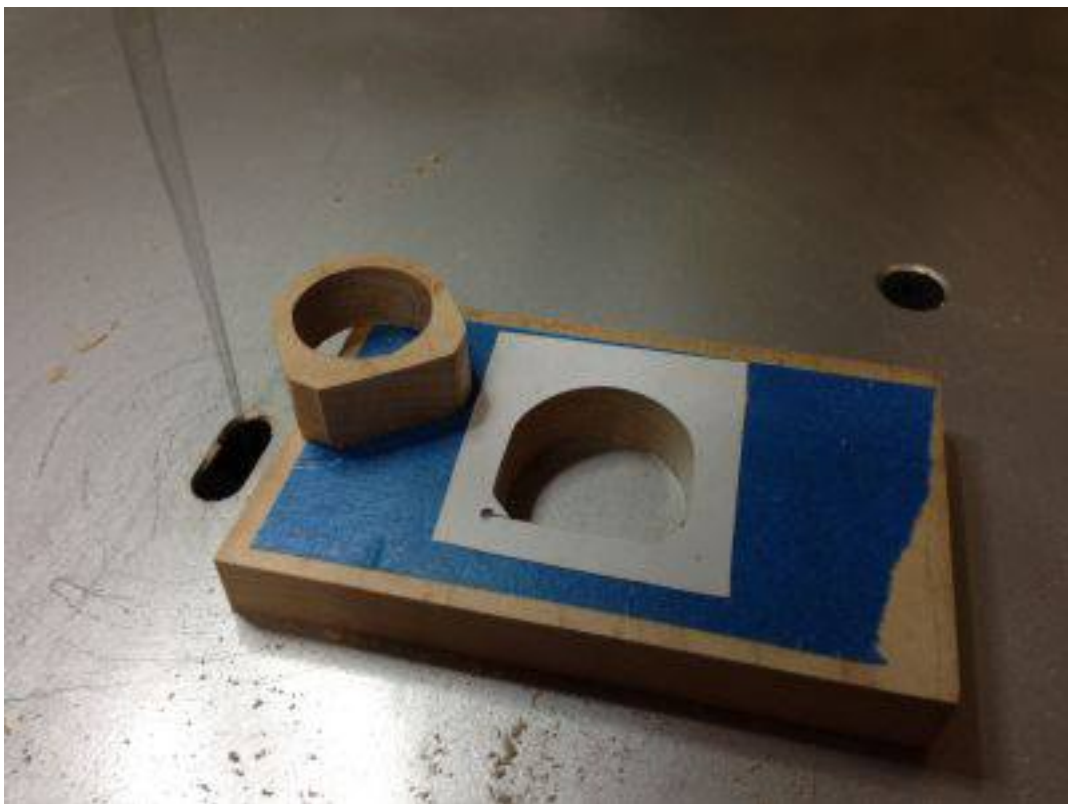

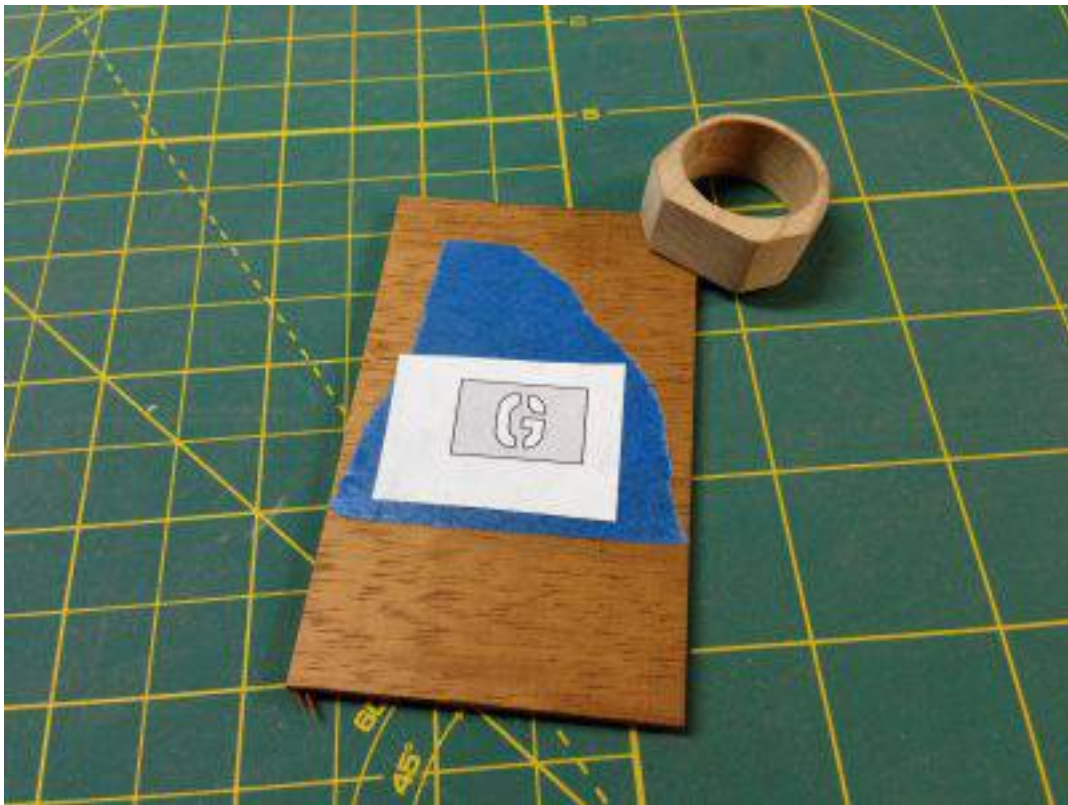

Apply the initial to the 1/8" thick contrasting wood and carefully cut the initial. It's kind of small so use a #1 blade. It is also a good idea to just nibble away the corners with the side of the blade. Do some sanding to clean out the inside of the ring to make it smooth and round. Don't over do it and change the size.





Glue the initial to the ring face. Notice how it over laps the ring.

We are going to take care of this by sanding it flush. Notice that I rounded over the edges of the ring. That's a very important detail.

Notice how the initial has been sanded to match the angle of the ring. The better the sanding job you do the more professional the ring will look. Take your time and get it right.



1/2" Thick wood.

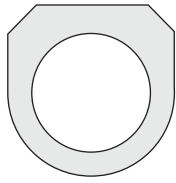

Size 5

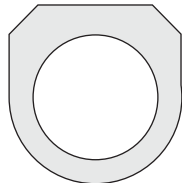

Size 6

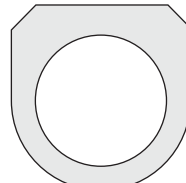

Size 7

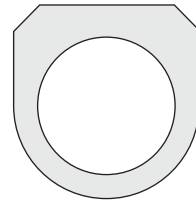

Size 8

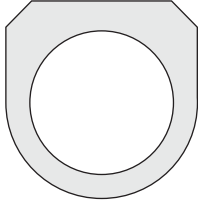

Size 9

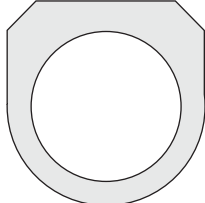

Size 10

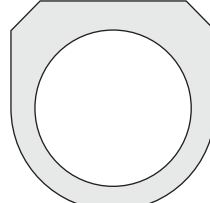

Size 11

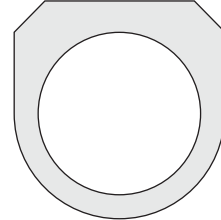

Size 12

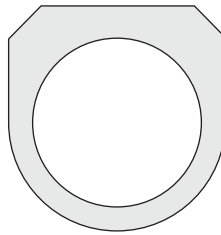

Size 13

The rings need to be custom sanded to fit.

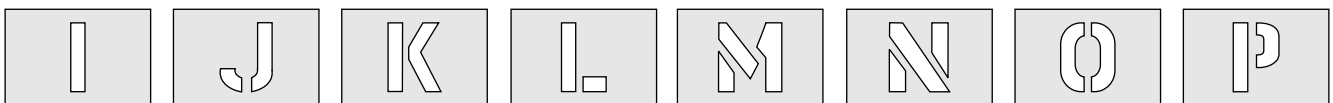

1/8" Thick wood.

