



Digital Patterns

Designed by
Steve Good

www.scrollsawworkshop.blogspot.com

Home of Scroll Saw Pattern Printer
and the Scroll Saw Key Chain Printer



Note to commercial print employees: I give my permission to print as many of this pattern book as your customer requires.

Light Bulb Bud Vase



Install the bulb then glue on the top ring.



To empty the light bulb you will need needle nose pliers and a 3/8" Allen wrench.



Use the needle nose to bend and remove the metal contact.

WEAR SAFETY GLASSES



Use a towel to protect your hand.



Pull out the metal contact.



Break out the ceramic seal.



Use the allen wrench to break the interior glass.



Pull out the filament.



Empty out the broken pieces.
Smooth out the interior ring.

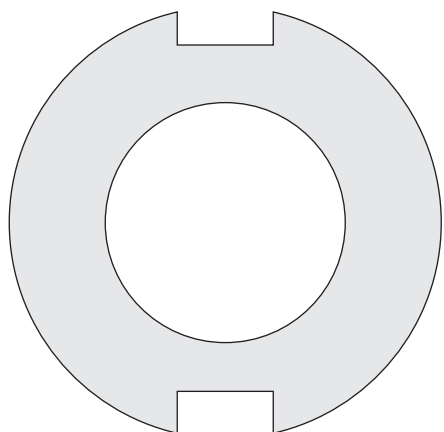

1/4" Thick

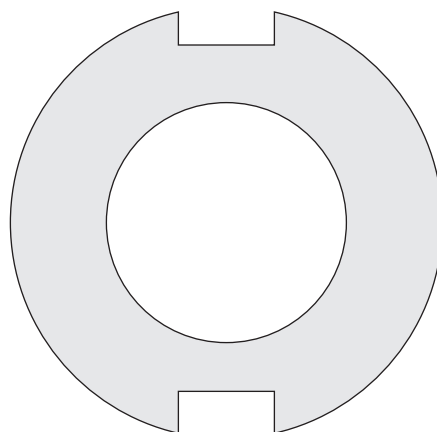

Glue on the bottom ring.
Install the bulb then glue on the top ring.

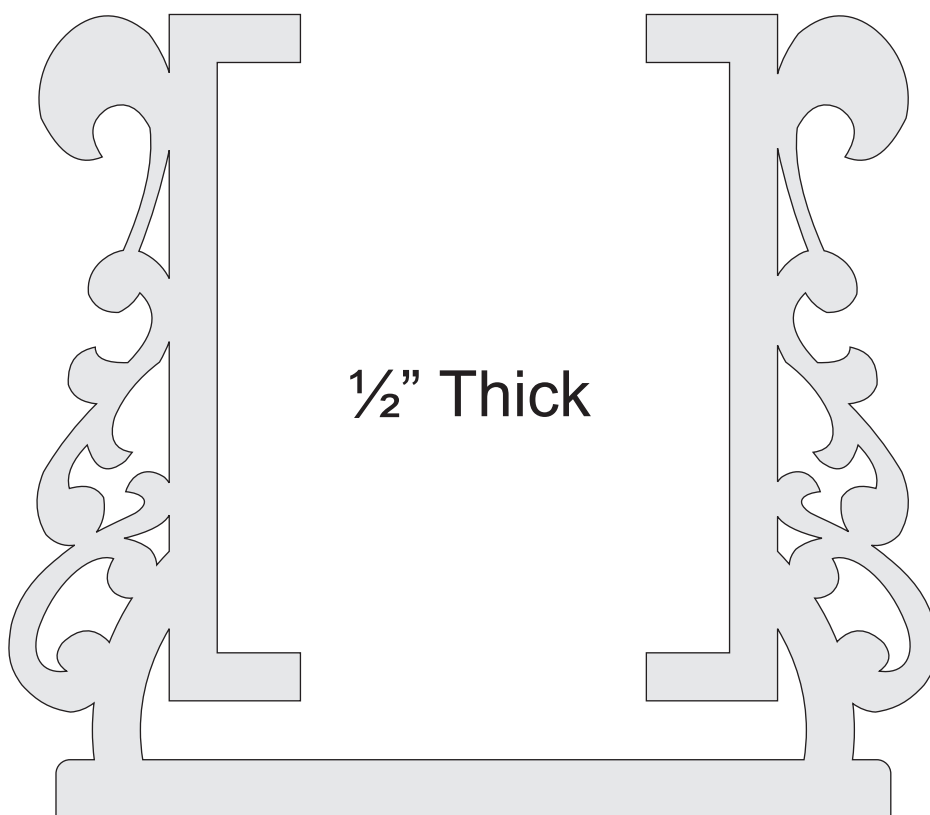

1/2" Thick

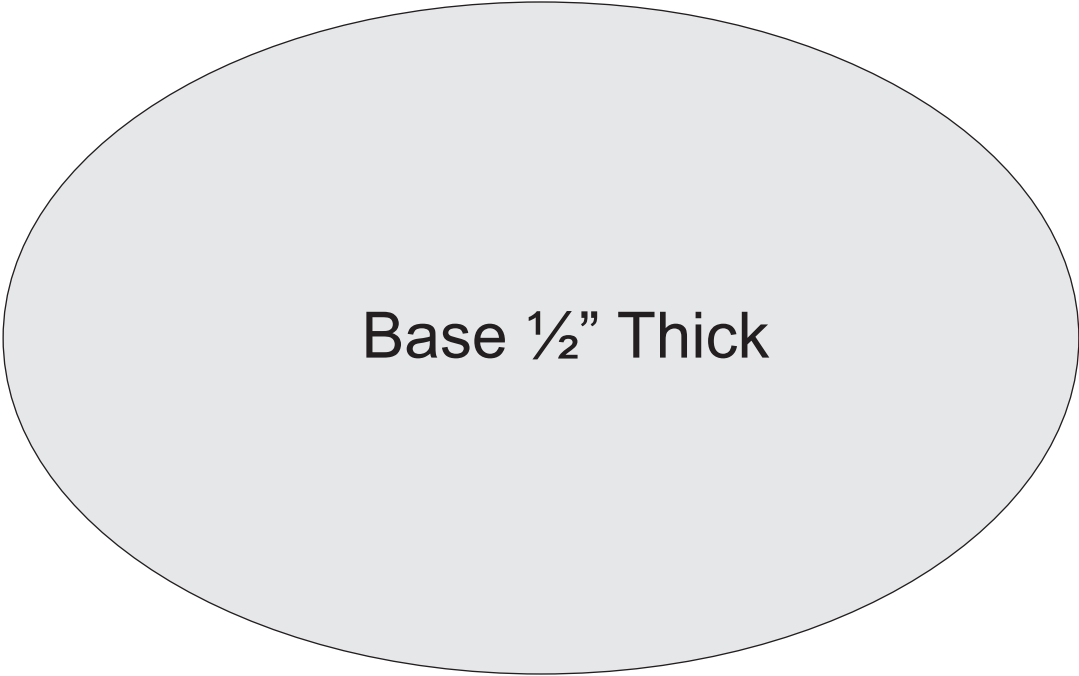

Base ½" Thick