

Digital Patterns



Designed by Steve Good

www.scrollsawworkshop.blogspot.com

Home of Scroll Saw Pattern Printer
and the Scroll Saw Key Chain Printer



Note to commercial print employees: I give my permission to print as many of this pattern book as your customer requires.

iPhone 5 Dock





This is an iPhone 5 dock for the lightning connector. Apple does not make a dock for the iPhone 5 so I made my own.

You should buy a second wall charger for this project. You will need to glue the connector into the dock making it unusable without the dock.

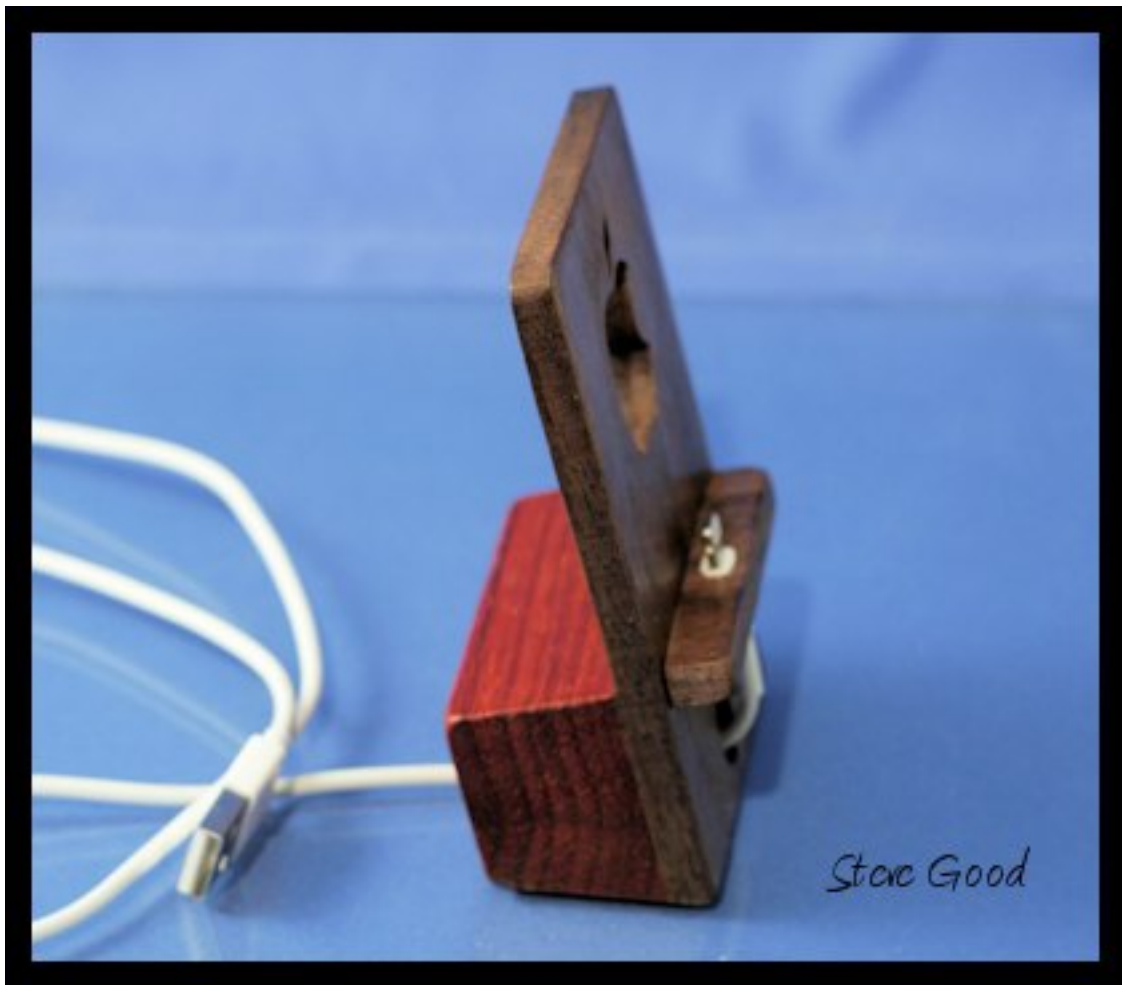

The bottom was sanded to a 15 degree angle after it was glued up. I used a disk sander with the table set to 15 degrees to do this.

You can make the fit of the connector very snug and avoid the glue but it's better glued in place.

You have to modify the shelf to compensate for the thickness of case if you have one on your phone. The thicker the case the more space you need from the connector hole to the back.

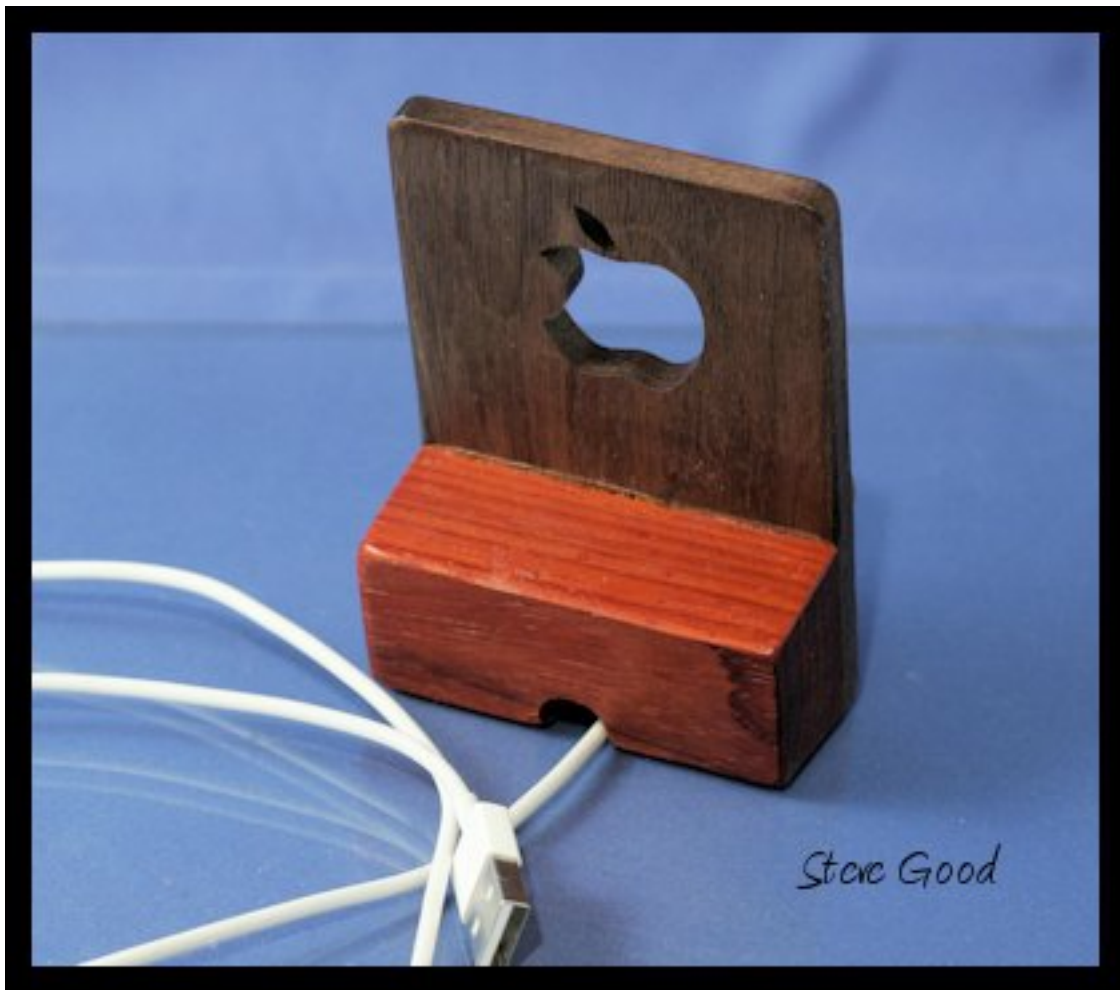

Notice that the $\frac{1}{2}$ inch hole for the cable is drilled all the way through the back and stand.

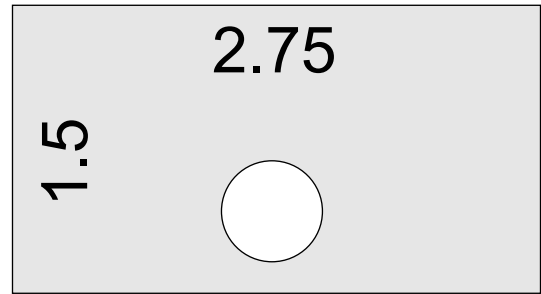
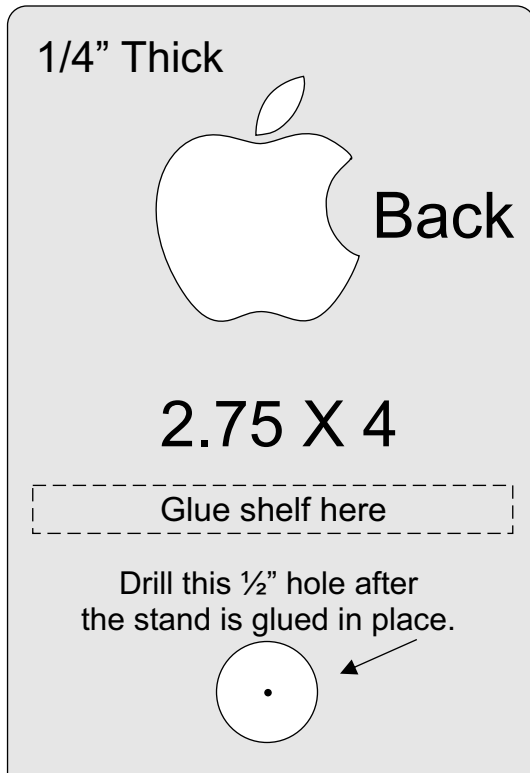

1 inch thick
Stand

Cut the connector hole then
use a small file to file to a snug fit.

Without Case



1/4" Thick

Case

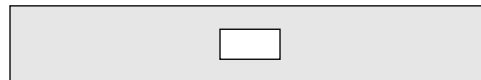

Shelf

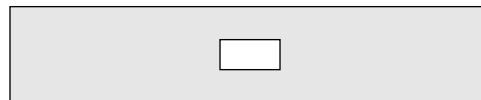

You may need to adjust the size of the
shelf to fit your case.